

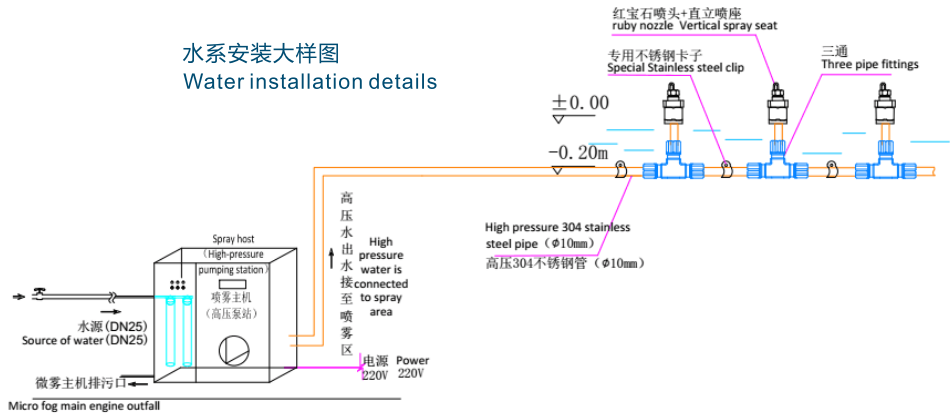

水系安装大样图
Water installation details



造雾机 型号 Artificial fog model	功率 (KW) Power (KW)	流量 (L/MIN) Pump flow (L/MIN)	工作压力 Working Pressure (Kg/cm²)	景观喷头 数量 Landscape nozzle (pc)	加湿喷咀 数量 Humidification nozzle (pc)	机器尺寸 Machine size (MM)	性能 Features
FL-001	0.55	2L	60	10--15	20	High pressure split machine 600*400*400	a、Motor : Fixed frequency motor b、High-pressure pump : Ceramic plunger pump c、Waterless protection switch d、10 inch RO filter in two series e、Pressure regulating valve: adjustable pressure f、Automatic hand control g、Inlet water solenoid valve anti-drip
FL-002	1.1	4L	60	15--25	40		



造雾机 型号 Artificial fog model	功率 (KW) Power (KW)	流量 (L/MIN) Pump flow (L/MIN)	工作压力 Working Pressure (Kg/cm²)	景观喷头 数量 Landscape nozzle (pc)	加湿喷咀 数量 Humidification nozzle (pc)	机器尺寸 Machine size (MM)	性能 Features
FL-003	1.1	6L	60	25--35	60	High pressure and rainproof integrated machine 700*500*1100	a、Motor: low speed motor b、High pressure pump: ceramic plunger pump c、Waterless protection switch d、10 inch RO filter in two series e、Pressure regulating valve: adjustable pressure f、Automatic dual time control g、Inlet water solenoid valve anti-drip
FL-004	1.5	8L	60	35--50	80		
FL-005	1.5	12L	60	50--70	120		
FL-006	2.2	15L	60	70--90	150		



造雾机 型号 Artificial fog model	功率 Power (KW)	流量 Pump flow (L/MIN)	工作压力 Working Pressure (Kg/cm²)	景观喷头 数量 Landscape nozzle (pc)	加湿喷咀 数量 Humidification nozzle (pc)	机器尺寸 Machine size (MM)	性能 Features
FL-007	3.0	21L	60	90--110	210	High pressure and rainproof integrated machine 900*650*1100	a、Motor: low speed motor b、High pressure pump: ceramic plunger pump c、Water pressure flow waterless protection switch d、20 inch RO filter in two series e、Pressure regulating valve: adjustable pressure f、Automatic dual time control g、Inlet water solenoid valve anti-drip
FL-008	3.0	23L	60	110-130	230		
FL-009	4.0	30L	60	130--170	300		
FL-010	4.0	30L	60	130--170	300	High pressure and rainproof machine with ultrafiltration 1200*700*1100	

HIGH PRESSURE COLD FOG SYSTEM 高压冷雾系统



利用高压造雾气系统将净化后的水滴以1-15微米（0.001mm）细雾形成喷射出来,似自然雾漂浮在空中,亦真亦幻,让人如身临仙境,心旷神怡.喷雾产生的大量负离子,能使空气新鲜湿润,改变局部小气候,雾气在迅速蒸发时吸收热量,达到降温、造景、净化空气的效果

Using high-pressure fog system to jet the purified water droplets in-15 microns (0.001mm)mist,looks like natural fog floating in the air,magic and looks ture, people feel in fairy land,relaxed and happy.The fog produce a large number of negative ions,make the air fresh and humid,change the local micro-climate,the rapid evaporation of the fog absorb heat,and reach cooling,landscaping,air purification effect.





数控摇摆喷头是通过专用精密机构把控制系统发出的数字脉冲信号精确地转变成安装于其上的喷头的摆动、转动或一定角度偏转的装置，运动角度、速度均可由控制系统数字化控制，具有输出转矩大、控制数字化、运动精确的优点。主要适用于音乐喷泉水量造型。

CNC swing nozzle is a device that precisely transform the digital pulse signal sent out by the control system into the installation by the specilized precision mechanism, which can make the nozzle swing, rotate at a certain angle. The movement angle and speed of CNC swing nozzle can be controlled by the digital control system. CNC swing nozzle has the advantages of large output torque, digital control system, precise movement, which is mainly suitable for water scape of music fountain.



技术参数TechniacI Parameter		
材质	Material	stainless steel 304
接口尺寸	Connector Size	进G2.5" ， 出G2" (external thread)
通径	DN	φ65/50
安装方式	Install mode	vertical
运动形式	Movement mode	rotate or swing
运动介质	Working medium	water
转动角	Angle of rotation	360° +A(A is any angle)
摆动角	Angle of oscillation	360° +A(A is any angle)
上维电机	Motor	rotate 7.25 cycles, swing 360°
下维电机	Motor	rotate 7.25 cycles, swing 360°
定位精度	Positional accuracy	0.5°
最大使用力	Maximum pressure	0.3 Mpa
总重量	Total weight	about 60KG
环境温度	Environment Temperature	0-40℃
水温度	Water Temperature	0-40℃
电源电压	Voltage	53±10% VAC (55VAC)
驱动方式	Drive mode	precision stepper motor
控制方式	Control mode	digital pulse type
控制脉冲电压	Control pulse voltage	5VDC
控制脉冲宽度	Control pulse width	>10 μ s
防护等级	Protection calss	Ip68
绝缘等级	Insulation class	B

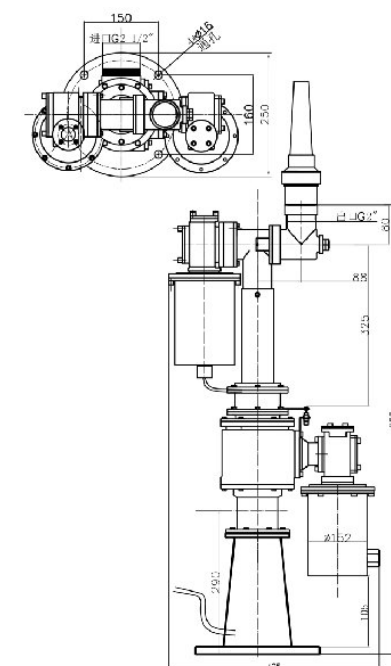



数控摇摆喷头是通过专用精密结构把控制系统发出的数字脉冲信号精确地转变成安装于其上的喷头的摆动、转动或一定角度偏转的装置，运动角度、速度均可由控制系统数字化控制，具有输出转矩大、控制数字化、运动精确的优点。主要适用于音乐喷泉中水景造型。

CNC swing nozzle is a device that precisely transform the digital pulse signal sent out by the control system into the installation by the specilized precision mechanism, which can make the nozzle swing, rotate at a certain angle. The movement angle and speed of CNC swing nozzle can be controlled by the digital control system. CNC swing nozzle has the advantages of large output torque, digital control system, precise movement, which is mainly suitable for water scape of music fountain.



技术参数TechniacI Parameter

材质	Material	stainless steel 304
接口尺寸	Connector Size	G1 1/2"(external thread) G2"
通径	DN	φ40/50
安装方式	Install mode	vertical or litle incline
运动形式	Movement mode	rotating or oscillating
运动介质	Working medium	water
转角与输入脉冲比	Ratio between angle and input pluse	360° /5800P
电机	Motor	(rotate 7.25 cycles)
喷头	Motor	(rotate 1 cycles)
定位精度	Positional accuracy	0.5°
最大使用力	Maximum pressure	0.3 Mpa
总重量	Total weight	about 16KG
环境温度	Environment Temperature	0-40°C
水温度	Water Temperature	0-40°C
电源电压	Voltage	53±10% VAC (55VAC, 55VAC is suggested)
驱动方式	Drive mode	precision stepper motor
控制方式	Control mode	digital pulse type
控制脉冲电压	Control pulse voltage	5VDC
控制脉冲宽度	Control pulse width	>10μs,上升沿有效 (Rising edge)
防护等级	Protection calss	Ip68(潜水深度≤1米) Rising edge≤1 metre
绝缘等级	Insulation class	B

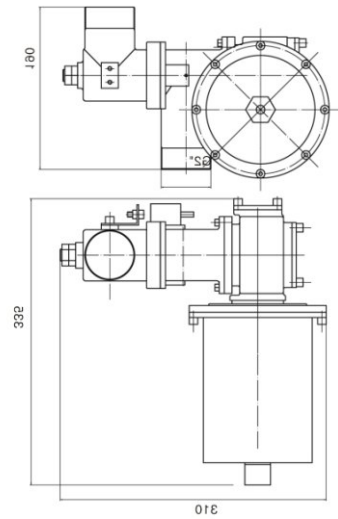

U

LTRT HIGH (SALUTE) NOZZLE

超高（礼炮）喷头

QINGTIAN JADE CHOPSTICK

擎天玉柱

该水型设计于喷泉的中心，是喷泉中喷射最高的水型,水柱粗壮挺拔,抗风性强,象征全国人民团结奋发、不怕困难、勇攀高峰。
The water in the fountain design center,is the highest water jet fountain,the water column staight sturdy,strong wind resistance,symbol of Na-tional People's unity and struggling,not afraid of difficulties,scaled new heights.



礼炮喷泉喷头是多孔散射喷头的一种，该喷头具有2分到2寸的多型接头，满足大多数场所的安装。有的也叫莲蓬喷头，他的喷射水状与花柱头稍有差异，喷出的水状也有差别，喷射时候正如燃烧的眼花，所以取名礼炮喷头，该喷头具有造型美观，安装简单，适合大多数场所安装。

Salute fountain is a porous scattering nozzle,the nozzle with 2 points to multi type joint 2 inch,meet most place.Some also called shower head,his jet water shape and style nozzle is slijhtly different,sprayed water way are differences,Spray as burning fireworks,so the name gun nozzle,the nozzle with beautiful appearance,simple installation,suitable for the majority of the installation.



技术参数TechniacI Parameter					
编号Item	喷嘴直径 Nozzle diameter	连接尺寸 joint size	工作压力 working pressure	喷水量 injection flow	喷射高度 jetting height
FL1100	30	2A-DN80	0.33-0.83	73-118	20-50
FL1101	38	2B-DN100	0.33-1.30	105-208	20-80
FL1102	45	3A-DN125	0.33-1.35	144-290	20-80
FL1103	50	3B-DN150	0.33-1.65	186-401	20-100
FL1104	63	4A-DN150	0.33-2.0	291-673	20-120





数字水幕是通过电磁阀的高频开闭，将水珠连续或不连续的下落，形成各种图案。
Digital Water Curtain Is Through Solenoid Valve High-frequency Open And Close, Continuous Or Discontinuous Drops The Water To Form Various Types Of Pattern

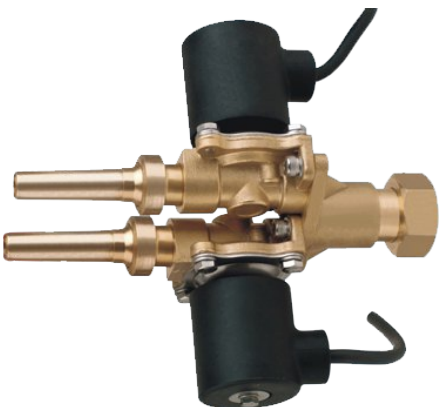

技术参数Techniacl Parameter	
动作方式 Move mode	直动式
形式 Type	常闭式
工作压力 Working Pressure	0-0.1Mpa
适用介质 Medium	水
介质温度 Medium Temperature	0-70℃
环境温度 Environment Temperature	0-50℃
选用电压 Voltage	DC48V
连接方式 Connetor	G1/2sw
功率 Power	25W
阀口通径 Diameter of vaive port	φ16
响应速度 Response speed	> 20次/秒
噪音 Noise	≤60分贝（1.5米处）





气爆的气体经过储气罐、气管能快速充满气跑发生器的器囊，经气跑专用数控阀通电打开，将储水口的水通过万向喷头快速喷出，并伴随“砰”的声响，速度达到每秒20次，气跑专用数控阀可以通过电脑控制，形成跑泉跳泉。

gas nozzle from air compressor quickly filled the airbag through gas generator and air pipe,the gas valve opens attter being energized,the water quickiy ejects through gimbaled nozzle,and20 times second.the valve can be controlled bycomputer, forming running spring and jumping spring.

技术参数TechniacI Parameter		
材质 Material	304不锈钢 (stainless steel 304)	
通径 DN	Φ40 Φ65 Φ80	
电压 Voltage	220V	
功率 Power	40W	
最大气压 Maximun pressure	1.2Mpa	
喷高 Height	About 50m	
喷口直径 Nozzle diameter	Φ3	
总重量 Total weight	90kg	





气爆的气体经过储气罐、气管能快速充满气跑发生器的器囊，经气跑专用数控阀通电打开，将储水口的水通过万向喷头快速喷出，并伴随“砰”的声响，速度达到每秒20次，气跑专用数控阀可以通过电脑控制，形成跑泉跳泉。

gas nozzle from air compressor quickly filled the airbag through gas generator and air pipe,the gas valve opens atter being energized,the water quickiy ejects through gimbaled nozzle,and20 times second.the valve can be controlled bycomputer, forming running spring and jumping spring.

技术参数TechniacI Parameter		
材质 Material	304不锈钢 (stainless steel 304)	
电压 Voltage	220V/380V	
功率 Power	25W	
最大气压 Maximun pressure	1.0Mpa	
喷高 Height	About 50m	
进水口 Inlet	φ40	
出水口 Outlet	φ32	
总重量 Total weight	36kg	

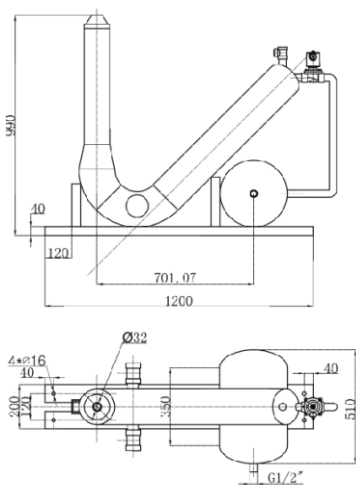

S

OLENOID VALVE

电磁阀



FLSV系列是最新开发的新一代音乐喷泉电磁阀，在元ZCST系列的功能基础上开发的，更具有零压差开启。开启水形高度一致等特点，特别适用于舞台，广场喷泉。

FLSV series products are newly developed solenoid valve for musical fountain on the basis of original FLSV series. Height of water shape is the same, especially suitable for the stage, square fountain.



FLSV Sereis

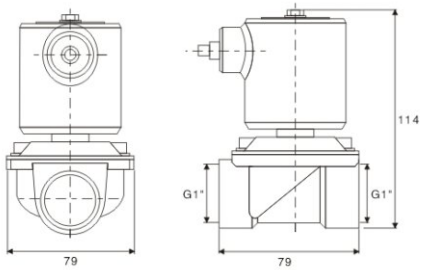

技术参数TechniacI Parameter		
材质	Material	黄铜 brass (SS304#)
通径	DN	25mm
外形尺寸	Connector Size	79*79*114mm
接口	Connection	管螺纹连接 Pipe threaded joint
环境温度	Movement mode	-20℃~+50℃
适用介质	Working medium	水 water
最大工作压力	Minimum working pressure	0.4Mpa
最小工作压力	Minimum working pressure	0Mpa
通用电压	Voltage	AC: 220V/110V/48V/36V/24V
功率	Power	25W
安装方式	Install model	Arbitrary(medium and arrow on valve areconsistent)

适用性 Applicability

- 管路中的流体必须和选用的电磁阀系列型号中标定的介质一致。
- 流体的温度必须小于选用电磁阀的标定温度。
- 电磁阀允许液体粘度在20CST以下，大于20CST应注明。
- 工作压差，管路最高压差在小于0.04Mpa时应选用如ZCSTZ、2W系列等直动式和分布式；最低工作压差大于0.04Mpa时可选用先导式（压差式）电磁阀；最高工作压差应小于电磁阀的最大标定压力;一般电磁阀都是单项工作,因此要注意是否有反压差,如有安装止回阀。
- 流体清洁度不高时应在电磁阀前安装过滤器，一般电磁阀对介质要求清洁度要好。
- 注意流量孔径和接管口径；电磁阀一般只有开关两位控制；条件允许请安装旁路管，便于维修；有水锤现象时要定制电磁阀的关闭时间调节。
- 注意环境温度对电磁阀的的影响。
- 电源电流和消耗功率根据输出容量选取，电源电压一般允许±10%左右，必须注意交流启动时VA值较高

- Fluid in the pipe must be consistent with medium that stated on solenoid valve.
- Fluid temperature must be lower than the stated temperature on solenoid valve.
- Fluid viscosity of Solenoid valve is generally lower than 20CST, if Higher, it should be specified.
- Working pressure, when maximum pressure less than 0.04Mpa, selecting ZCSTZ, 2W series direct-acting and sub-step types; minimum working pressure is more than 0.04Mpa selecting pilot (differential pressure) solenoid valve; maximum working pressure should be lower than the maximum pressure of solenoid valve; generally solenoid valves is one-way working, so pay attention to whether there is an ti-pressure, if do installed check valve.
- When fluid cleanliness is not high, the filter should be installed on solenoid valve, solenoid valve has high requirements to the media cleanliness.
- Notice flow aperture and caliber; solenoid valve generally only two control switches; conditions allowed, install the bypass pipe, for easy maintenance; adjust the opening and closing time water when hammer phenomenon appears.
- Notice that environmental temperature affects the electromagnetic valve.
- Current and power consumption ± 10%, must notice VA is high when starting the exchange value.

选用规格 Specifications						
型号 Model	通径 DN (mm)	外形尺寸Connector Size (mm)			重量 Weight(kg)	接口 Connection
FS-15	15	69.3	79	97	0.87	G1/2''(内螺纹internal thread)
FS-20	20	79	79	105	1.3	G3/4''(内螺纹internal thread)
FS-25	25	79	79	114	1.2	G1''(内螺纹internal thread)
FS-32	32	118	87.5	138	2.1	G1 1/4''(内螺纹internal thread)
FS-40	40	112	95.5	154	2.45	G1/2''(内螺纹internal thread)
FS-50	50	155	122	174	3.5	G2''(内螺纹internal thread)

可靠性 Reliability

- 电磁阀分为常闭和常开二种；一般选用常闭型，通电打开，断电关闭；但在开启时间很长关闭时很短时要选用常开型。
- 寿命试验，工厂一般属于型式试验项目，确切的说我国还没一电磁阀的专业标准，因此选用电磁阀厂家时慎重。
- 动作时间很短频率较高时一般选取自动式，大口径选用快速系列。
- solenoid valve normally divided into two types; closed and open types; general use normally closed, open when power on, close when power off. However, turning on for a very long time and turn off for very short time, use the normally open type.
- Life test, factory belongs to type pilot project, and China has not exactly professional standards of solenoid valve, so choose carefully solenoid valve manufacturers.
- When action time is very short and high frequency generally select direct acting,large-caliber choose rapid series.

安全性 Safety

- 一般电磁阀不防水，在条件不允许时请选用防水型，工程可以定做。
- 电磁阀的最高标定公称压力一定要超过管路内的最高压力，否则使用寿命会缩短或产生其他意外情况。
- 有腐蚀性液体的应选用全不锈钢型，腐蚀性流体宜选用316不锈钢电磁阀。
- 爆炸性环境必须选用相应的防爆产品。

- General solenoid valve is not waterproof, use waterproof when the conditions are not allowed, factories can be customized.● The highest nominal pressure of solenoid valve must be higher than maximum pressure in the pipe, otherwise life will be shortened or cause other unforeseen circumstances.
- Corrosive liquids should use all stainless steel solenoid valve, and strong corrosive fluids should use 316 stainless steel solenoid valve.
- Using the appropriate explosion proof product in explosive environment.

经济性 Economy

- 有很多电磁阀可以通用，在能满足以上三点的基础上应选用最经济的产品。
- Many solenoid valve are generic, but meet the above three points, should be choose the most economical products.



百变喷泉是最近几年才出现的一种新水型，它克服了传统喷泉形状单一规定的水型缺点、采用了先进的变速技术和音控频率相结合的经验,水型水柱的高低\喷水宽度的范围均有节奏的高低起缩和四周扩张、收缩，犹如水中玉女、款款起舞、婀娜多姿、身形百变、清新奇妙。

Variety fountain is only appeared in recent years,a new form of water,He has overcome the traditional shape of a single fixed water fountain shaped shortcomings,The use of advanced transmission technology and sound control frequency combination of experience,Water shape changes from high to low,and slowly close to four weeks expansion,Like fairy dancing in the water.



技术参数 Technical Parameter					
编号No.	连接尺寸 Connection	工作压力 Presure (Kpa)	喷水量 Discharge (M3/H)	喷射高度 Height (M)	覆盖直径 Diameter (M)
FLBV2610	Dn40	50-200	30	3.2	3
FLBV2611	Dn50	50-200	35	3.5	3.5





火喷是通过一种特殊装置将燃气燃料挤压到高空后产生剧烈爆炸，形成硕大、绚丽的圆形火球，并伴有耀眼的光芒和浑厚的声响。与喷泉、音乐想结合后，更能展现其辉煌灿烂。

Fire fountain is morking through a special setting,extrusion gas fuel to thehigh altitude,will cause fierce explosion,then can makea big and gorgeousand fire ball,with dazzling lighting and powerful sound.Together with fountain and music,it will be more brilliant and beautiful effect.

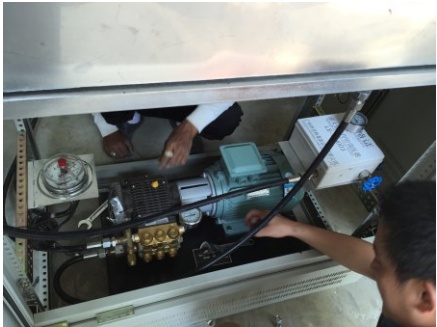

FLF-新型（环保）火泉
FLF- New (environmentally friendly) fire spring

一套火泉装置系统一般可控制：火泉6-8枚(喷高3-8米)
A set of fire spring system can generally be controlled: 6-8 fire springs (spray height 3-8 meters)

编号 No.	名 称 Item	型号 Model	备注 Remarks	单位 unit
1	电子可控焰火喷火装置（不锈钢） Electronically controllable fireworks (stainless steel)	CD25-3-A(BY-02)	个 PC	水仙子 Water Faery
2	火泉装置平台 Fire spring installation platform	HC-004	套 set	水仙子 Water Faery
3	DVP-V1.08 电柜（带远程接口） DVP-V1.08 electric cabinet (with remote interface)	BK1-1	台 set	水仙子 Water Faery
4	扫描开关 Scan switch	LE-S-H002	套 set	水仙子 Water Faery
5	特制高压软管 Special high pressure hose	Dn16	米 M	水仙子 Water Faery
6	特制高压专用对接管 Special high pressure special butt joint	Dn10	根 PC	水仙子 Water Faery
7	喷火管路均恒调压器 Squirting line constant voltage regulator	LE-T-H003	套 set	水仙子 Water Faery
8	供燃料系统（发射台） Fuel supply system (launch station)	0Y-016	套 set	水仙子 Water Faery
9	火泉主机（进口）总成 Fire spring host (import) assembly	LE-P-H00/4K	套 set	水仙子 Water Faery

备注:本火泉的燃料采用特制的添加剂配方,遇明火而不燃安全可靠，非易非爆的液体。燃料分析:可以控制射程流量：一般喷火高度3—8米。另外特制高压软管根据现场实际需要如需增加另外按照实际需要米数按实计算。
Remarks: The fuel of this fire spring is made of special additive formula, which is safe and reliable when exposed to open flames. It is not easy to non-explosive liquid. Fuel analysis: can control the range flow: the general height of the fire is 3-8 meters. In addition, the special high-pressure hose is added according to the actual needs of the site.

WATER SCREEN MOVIE 水幕电影

吉祥尊贵的水型，5组水型，分别布置在喷泉的前后，喷高4米，构成逐渐 展开的水形，形似孔雀开屏，在变频器的控制下，可随音乐节拍跳动，造型优美而富有动感。
Auspicious distinguished 5 groups of water, water, are respectively arranged around the fountain, spray height 4 meters, the water shape gradually, resembling a peacock, in the inverter control, with the music rhythm, elegant and dynamic.



水幕喷头可喷出扇形的、直径高度都达数十米的巨幅雾状的水幕。
与激光发生器、水幕电影机配合表演，在水幕上打出色彩斑斓的图形、文字，播放水幕电影，表演的效果极佳。雾化的水幕使得画面产生虚无缥缈的梦幻般的感觉，配以变化万千的水景，让游人的思绪为之自由驰骋。水幕喷头适用于江、河、湖、海及室外场合，具有极佳的营业性能。



The water curtain nozzle can sprayefan diameter tens of meters high,with a mist of water curtain.Perfoemance match with the laser generator,water curtain film,withcolorful graphics,text in the water curtain movie,play.excellent performance of.The atomization water curtain screen with no reality whatever fantastic feeling,with the ever-changging features let viitors mind free. The warer curtain nozzle is suitable for jiang,river,lake,sea and outdoor occasions ,business performance.

技术参数 Technical Parameter				
编号 No.	连接尺寸 Connection	水幕尺寸 Size of screen (M)	建议水泵 Pump suggested	建议投影仪 Projector suggested (Lumen)
1	Dn65	10-15	7.5KW x 2	10000
2	Dn80	15-20	11KW x 2	10000-12000
3	Dn100	20-25	15KW x 3	12000-14000
4	Dn150	25-30	45KW x 3	14000-16000
5	Dn200	40	55KW x 4	16000x2



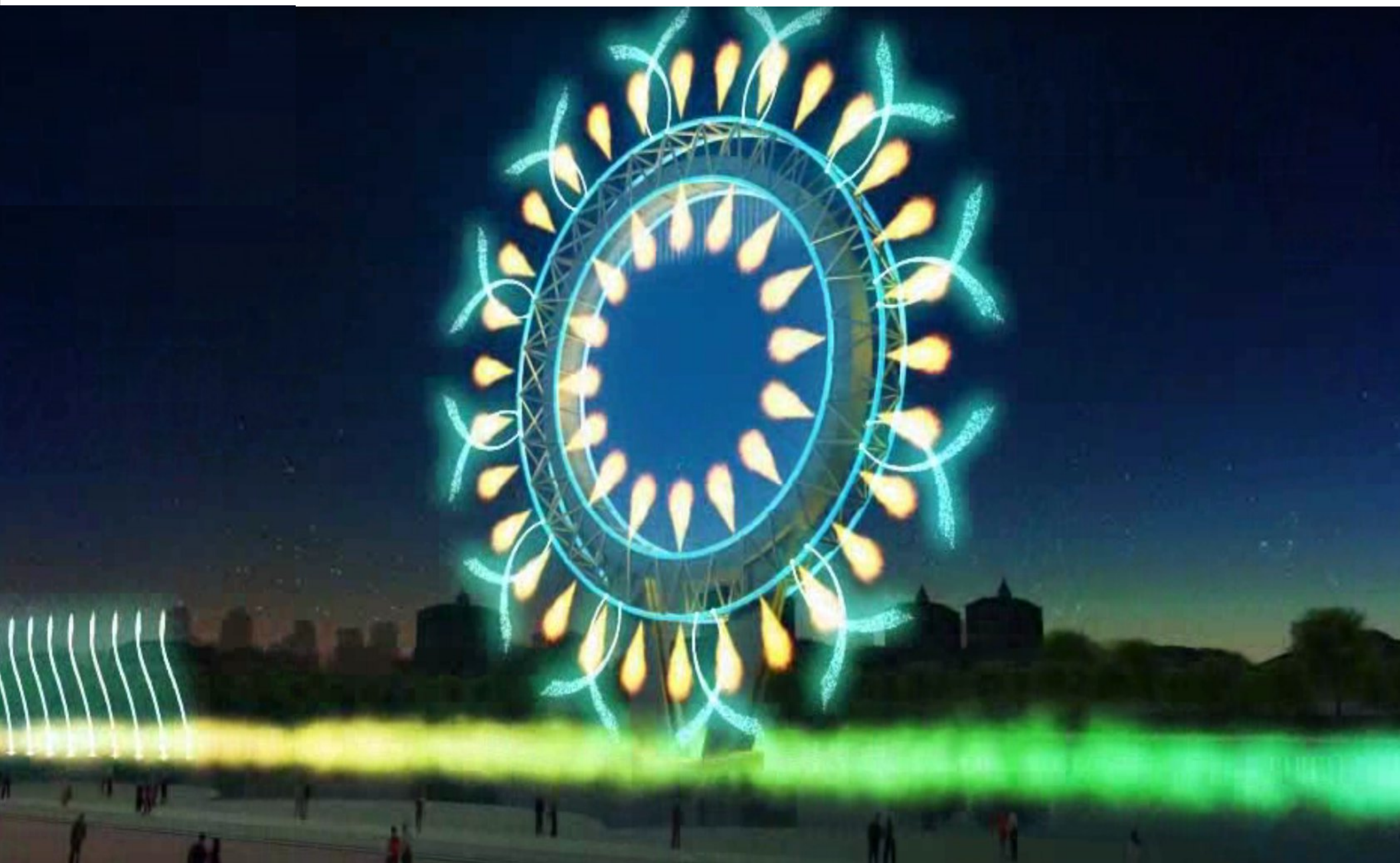

喷泉长达180米，宛若一个巨大的电影屏幕，总统的形象，奔驰的骏马、展翅的雄鹰、都市楼宇,通过高科技水幕投影技术在O圈屏幕上演绎着现代化文明都市的进程，我们摒弃了单一传统的技术，糅合了音乐喷泉、水幕电影、火焰、灯光、激光等多种创意，水火相融，光影交错、水舞摇曳，整场水秀表演非常地华丽壮观，美不胜收！

Fountain length 180m, which just looks like a huge movie screen, the image of the president, the galloping horse, the winged eagle, urban buildings, using the high-tech water curtain projection technology modernization to illustrate the process of civilized cities on the O-ring screen. Abandon the traditional and single technology, but combine musical fountains, water movie curtains, flames, lights, lasers and other ideas, water and fire, light and shadow, water dance sway, the whole water show is very magnificent and beautiful!



技术参数 Technical Parameter

长度 length	180m
内直径 Internal diameter	φ17m
外直径 External diameter	φ23m
总高度 Total height	31m
重量 Weight	460t

